

MATERIAL AND FINISHES:

SMA:  
 BODY, CRIMP TUBE, NUT: BRASS / PLATED GOLD  
 CONTACT: BERYLLIUM COPPER / PLATED GOLD  
 INSULATOR: TEFLON  
 LOCK WASHER: PHOSPHOR BRONZE / PLATED GOLD  
 HEAT SHRINK TUBE: VERSAFIT / BLACK

MICRO COAXIAL  
 BODY, CONTACT: PHOSPHOR BRONZE / PLATED GOLD  
 HOUSING: PBT  
 CABLE: 1.37MM CABLE

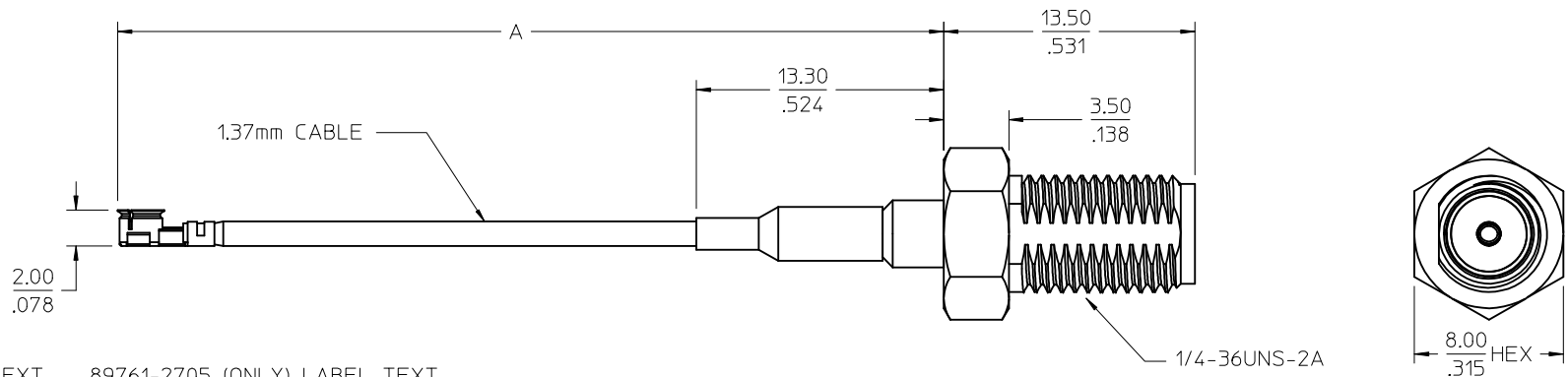
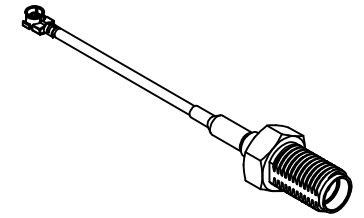

89761-2704 (ONLY) LABEL TEXT  
 INDIVIDUAL BAG 128 SYMBOLOGY:

89761-2705 (ONLY) LABEL TEXT  
 INDIVIDUAL BAG 128 SYMBOLOGY:

DATE CODE: YYWW  
 BAR CODE  
 VND P/N: 89761-2704  
 BAR CODE  
 HONEYWELL P/N: 600-00303  
 BAR CODE  
 QTY: 1 MFG: MOLEX  
 BAR CODE BAR CODE

DATE CODE: YYWW  
 BAR CODE  
 VND P/N: 89761-2705  
 BAR CODE  
 HONEYWELL P/N: 600-00278  
 BAR CODE  
 QTY: 1 MFG: MOLEX  
 BAR CODE BAR CODE

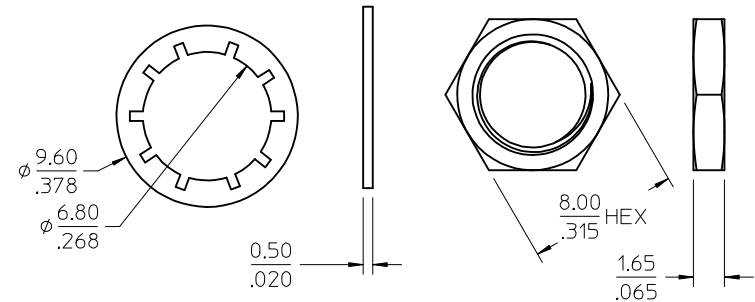

89761-2705	150.00±5.00	5.906±.197	SEE NOTE
89761-2704	360.00±6.35	14.173±.250	SEE NOTE
89761-2703	40.00±4.00	1.575±.157	NONE
89761-2702	65.00±4.00	2.559±.157	NONE
89761-2701	127.00±4.00	5.000±.157	NONE
89761-2700	203.20±4.00	8.000±.157	NONE
PART NO.	MM	IN	BAG LABEL
A			

CHANGE TITLE PER RF15-E178 EC NO: URF2015-0581 DRWNLIN 2015/04/21 CHKD: APPR: YCHENG 2015/04/27 REV: D1	QUALITY SYMBOLS	GENERAL TOLERANCES (UNLESS SPECIFIED)	DIMENSION STYLE	SCALE	DESIGN UNITS	THIRD ANGLE PROJECTION	
	▽=0 ▽=0	mm INCH 4 PLACES ± --- ± --- 3 PLACES ± --- ± --- 2 PLACES ± --- ± --- 1 PLACE ± --- ± --- ANGULAR ± 2 °	MM/IN	DRAWN BY DATE DARRY 2008/05/15 CHECKED BY DATE JUDY 2008/05/15 APPROVED BY DATE MISEN 2008/05/15	METRIC	MOLEX INCORPORATED SD-89761-270	SHEET NO. 1 OF 1
	DRAFT WHERE APPLICABLE MUST REMAIN WITHIN DIMENSIONS	SEE TABLE	DOCUMENT NO.	THIS DRAWING CONTAINS INFORMATION THAT IS PROPRIETARY TO MOLEX INCORPORATED AND SHOULD NOT BE USED WITHOUT WRITTEN PERMISSION			