

13 12 11 10 9 8 7 6 5 4 3 2 1

MATERIALS AND FINISHES:

SMA JACK STR BKHD

BODY BRASS
PLATED GOLD

CONTACT PHOSPHOR BRONZE
PLATED GOLD

INSULATOR TEFLON

JAM NUT BRASS
PLATED GOLD

LOCK WASHER SPCC
PLATED GOLD

UFL

BODY PHOSPHOR BRONZE
PLATED GOLD

CONTACT PHOSPHOR BRONZE
PLATED GOLD

INSULATOR PBT

CABLE DIA 1.13 OR EQUIVALENT
COLOR GRAY

SHRINK TUBE VERSAFIT

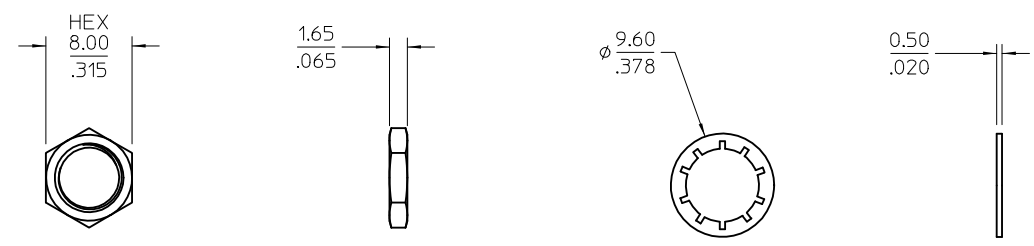
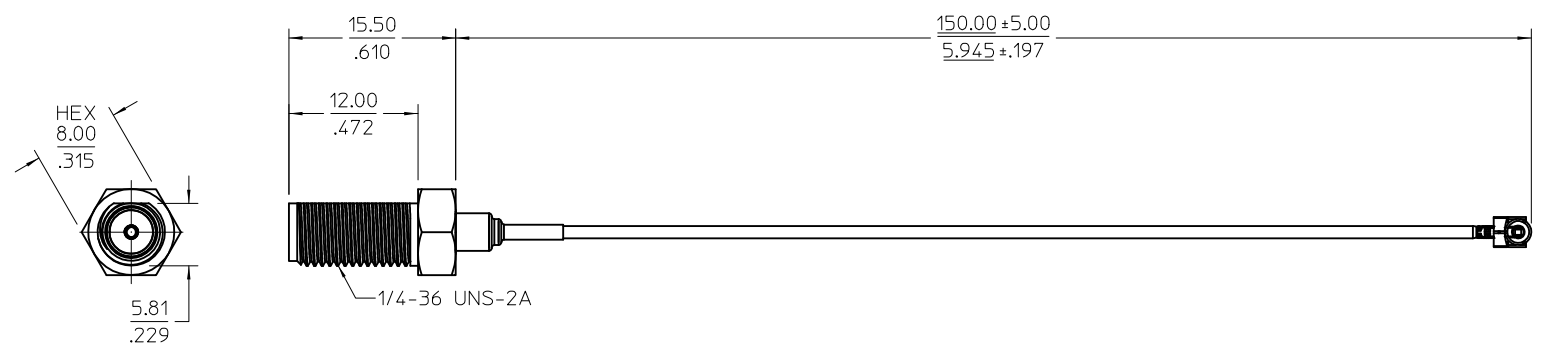
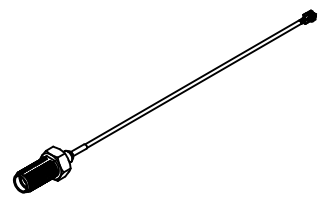

PRE-RELEASE
REFERENCE
USE ONLY

CHG/NEW RELEASE PER PDR1110926	DRW: RYEH	DESCRIPTION
	CHKD: KERRIE	QUALITY SYMBOLS
APPR:	1	▽=0

GENERAL TOLERANCES (UNLESS SPECIFIED)	
mm	INCH
4 PLACES ± .005	± .0005
3 PLACES ± .002	± .0002
2 PLACES ± .001	± .0001
1 PLACE ± .0005	± .00005
ANGULAR ± 2 °	
DRAFT WHERE APPLICABLE MUST REMAIN WITHIN DIMENSIONS	

DIMENSION STYLE	
MM/IN	
DRAWN BY	DATE
RYEH	2011/10/31
CHECKED BY	DATE
KERRIE	2011/10/31
APPROVED BY	DATE
MATERIAL NO.	
897623250	

SCALE	DESIGN UNITS	THIRD ANGLE PROJECTION
	METRIC	
TITLE		
CA SMA JACK STR BKHD TO UFL WITH 1.13 CABLE CA-SMAJ/UFL		
MOLEX INCORPORATED		
MATERIAL NO.	DOCUMENT NO.	SHEET NO.
897623250	SD-89762-325	1 OF 1
THIS DRAWING CONTAINS INFORMATION THAT IS PROPRIETARY TO MOLEX INCORPORATED AND SHOULD NOT BE USED WITHOUT WRITTEN PERMISSION		

12 11 10 9 8 7 6 5 4 3 2 1

2011/10/31