

MATERIAL&FINISHES:

BODY:BRASS PLATED NICKEL

HOOK :BRASS/PLATED GOLD 1u MICROINCH MIN.

CONTACT PIN/SIDE CONTACT:BRASS
PLATED GOLD 10u MICROINCH MIN.

MALE CONTACT:BRASS
PLATED GOLD 30u MICROINCH MIN.

INSULATOR:TEFLON

SPRING :STAINLESS STEEL

JUM NUT :BRASS
/ PLATED GOLD 1u MICROINCH MIN.

LOCK WASHER :PHOSPHOR BRONZE
PLATED GOLD 1u MICROINCH MIN.

PACKING :

1)73253-5040 BY TRAY

2)73253-5041 BY TRAY

NUT/WASHER BY POLY BAG

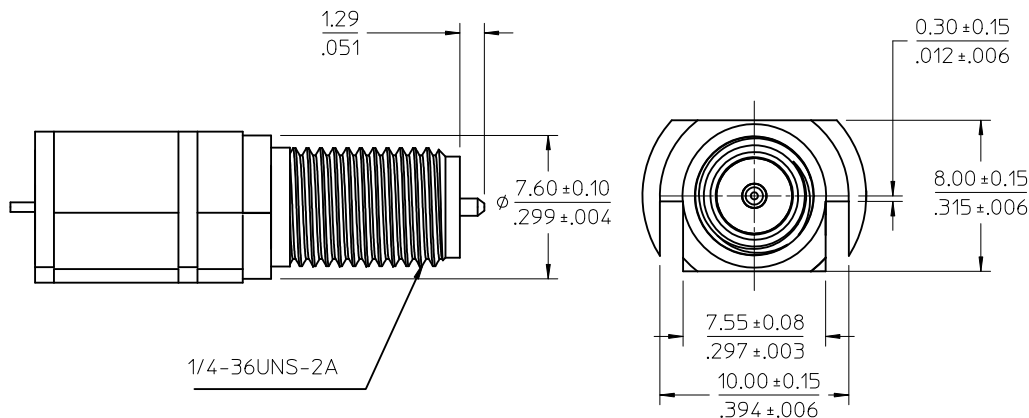
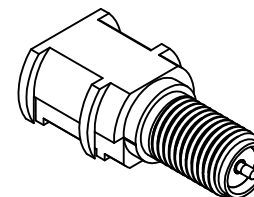
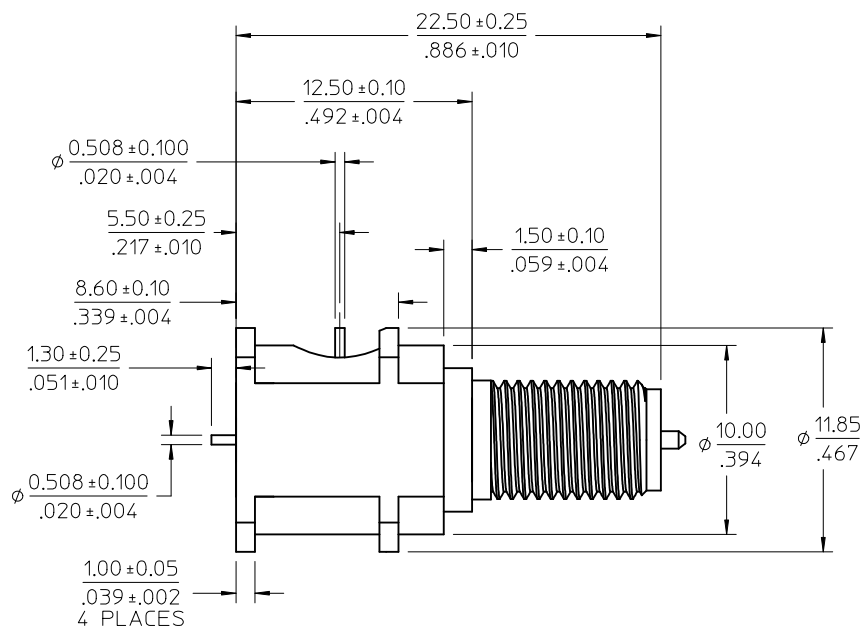

| | | |
|---|------------|---------------------------------|
| 2 | 73253-5041 | WITH LOCK WASHER AND JAM NUT |
| 1 | 73253-5040 | WITHOUT LOCK WASHER AND JAM NUT |
| | PART NO. | DESCRIPTION |

| | |
|---------------|---------------------|
| PS-73598-047 | EE/MECH PERFORMANCE |
| SPECIFICATION | DESCRIPTION |

| | | | | | | | |
|-------------------------------|---|-----------------|---|---------------------------------------|--|--|------------------------|
| CHG:PACKING ADD 73253-5041 | EC NO: URF2010-0457 | QUALITY SYMBOLS | GENERAL TOLERANCES (UNLESS SPECIFIED) | DIMENSION STYLE | SCALE | DESIGN UNITS | THIRD ANGLE PROJECTION |
| | DRWN:YCHENG 2010/02/03 CHKD:ALEX 2009/5/19 APPR:MHUANG 2010/02/05 | ▽=0 ▽=0 | mm INCH | MM/IN | METRIC | ⊙ | |
| B1 | REV | DESCRIPTION | 4 PLACES ± --- ± --- 3 PLACES ± --- ± --- 2 PLACES ± 0.13 ± --- 1 PLACE ± 0.25 ± --- | DRAWN BY DATE DARRY 2009/5/19 | TITLE | SMA JACK REVERSE SWITCH EDGE LAUNCH - LEFT SMA-J/SMT | |
| | | | ANGULAR ± 2 ° | CHECKED BY DATE ALEX 2009/5/19 | MOLEX INCORPORATED | | |
| | | | DRAFT WHERE APPLICABLE MUST REMAIN WITHIN DIMENSIONS | APPROVED BY DATE MHUANG 2010/02/05 | DOCUMENT NO. | SD-73253-504 | |
| | | | | MATERIAL NO. | SEE TABLE | | |
| | | | | SIZE | THIS DRAWING CONTAINS INFORMATION THAT IS PROPRIETARY TO MOLEX INCORPORATED AND SHOULD NOT BE USED WITHOUT WRITTEN PERMISSION | | |

ACCESSARY NO NEED TO APPROVE BY CUSTOMER

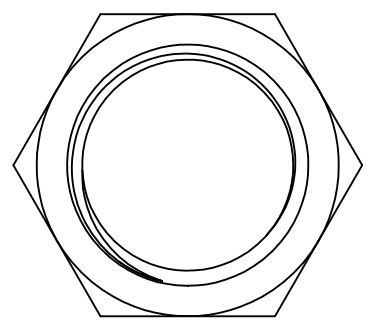

NUT

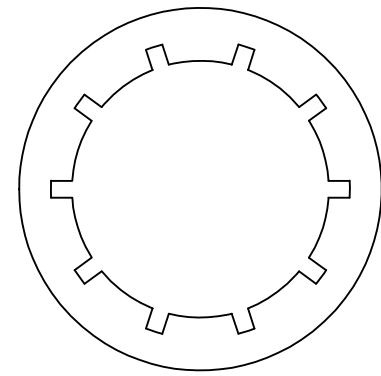

WASHER

| | | | | | | | | | | | | |
|--|------------------------|-------------------------------|---------------------------------------|--|--------------------------|---|--|------------------------|------------------------|--|--|--|
| CHG: SEE SHEET 1 EC NO: URF2010-0457 DRWN:YCHENG 2010/02/03 CHKD:ALEX 2009/5/19 APPR:MHUANG 2010/02/05 | DESCRIPTION REV: B1 | QUALITY SYMBOLS ▽=0 ▽=0 | GENERAL TOLERANCES (UNLESS SPECIFIED) | | DIMENSION STYLE MM/IN | | SCALE | DESIGN UNITS METRIC | THIRD ANGLE PROJECTION | | | |
| | | 4 PLACES ± --- ± --- | | DRAWN BY DARRY | DATE 2009/5/19 | TITLE SMA JACK REVERSE SWITCH EDGE LAUNCH - LEFT SMA-J/SMT | | | | | | |
| | | 3 PLACES ± --- ± --- | | CHECKED BY ALEX | DATE 2009/5/19 | MOLEX INCORPORATED | | | | | | |
| | | 2 PLACES ± 0.13 ± --- | | APPROVED BY MHUANG | | DATE 2010/02/05 | DOCUMENT NO. SD-73253-504 | | SHEET NO. 2 OF 4 | | | |
| 1 PLACE ± 0.25 ± --- | | ANGULAR ± 2 ° | | DRAFT WHERE APPLICABLE MUST REMAIN WITHIN DIMENSIONS | | SIZE C | THIS DRAWING CONTAINS INFORMATION THAT IS PROPRIETARY TO MOLEX INCORPORATED AND SHOULD NOT BE USED WITHOUT WRITTEN PERMISSION | | | | | |

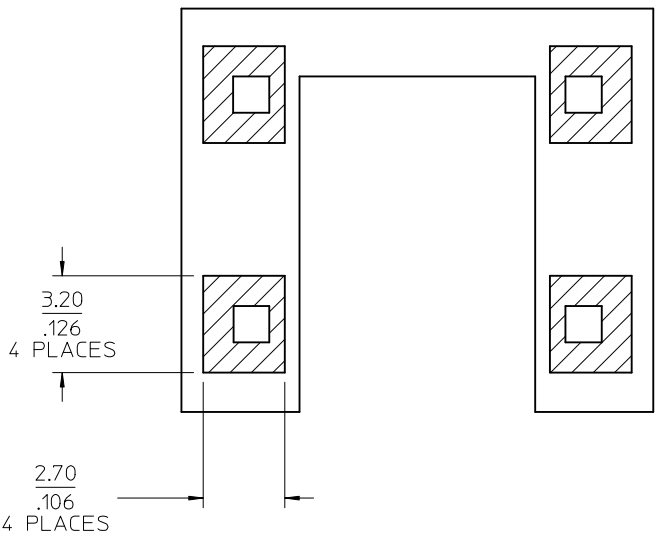
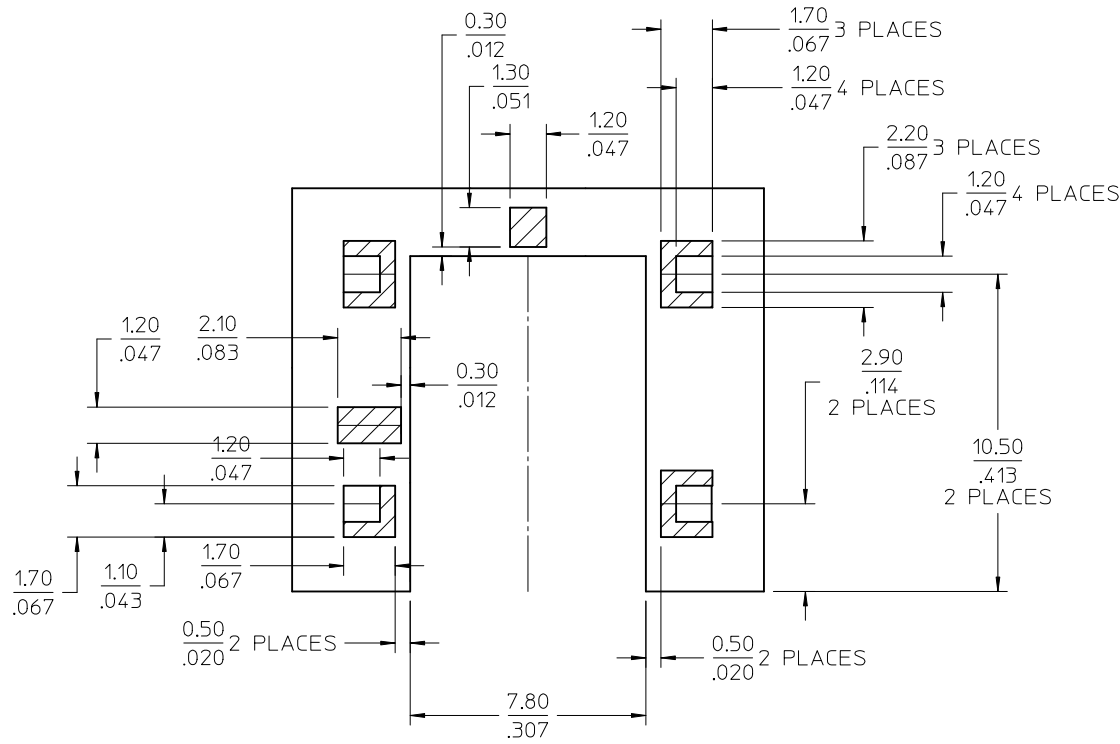

PCB FRONT VIEW

PCB BACK VIEW

RECOMMEND PCB LAYOUT DIMENSION

CHG: SEE SHEET 1

EC NO: URF2010-0457
 DRWN: YCHENG 2010/02/03
 CHKD: ALEX 2009/5/19
 APPR: MHUANG 2010/02/05

| REV | DESCRIPTION |
|-----|-------------|
| B1 | |

QUALITY SYMBOLS
 ▽=0
 ▽=0

GENERAL TOLERANCES (UNLESS SPECIFIED)

| | mm | INCH |
|----------|--------|--------|
| 4 PLACES | ± .13 | ± .005 |
| 3 PLACES | ± .13 | ± .005 |
| 2 PLACES | ± 0.13 | ± .005 |
| 1 PLACE | ± 0.25 | ± .010 |

ANGULAR ± 2 °

DRAFT WHERE APPLICABLE MUST REMAIN WITHIN DIMENSIONS

| DIMENSION STYLE | |
|-----------------|------------|
| MM/IN | |
| DRAWN BY | DATE |
| DARRY | 2009/5/19 |
| CHECKED BY | DATE |
| ALEX | 2009/5/19 |
| APPROVED BY | DATE |
| MHUANG | 2010/02/05 |
| MATERIAL NO. | |
| SEE SHEET 1 | |

| SCALE | DESIGN UNITS | THIRD ANGLE PROJECTION |
|--|--------------|------------------------|
| | METRIC | |
| TITLE | | |
| SMA JACK REVERSE SWITCH EDGE LAUNCH - LEFT SMA-J/SMT | | |
| MOLEX INCORPORATED | | |
| DOCUMENT NO. | SHEET NO. | |
| SD-73253-504 | 3 OF 4 | |

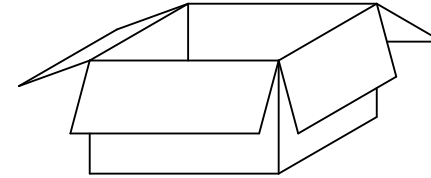
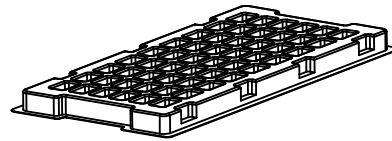
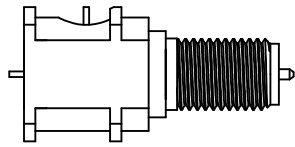

54 PCS PER ONE TRAY
360 mm REF. * 170 mm REF.

10 TRAYS (540 PCS) IN ONE INNER CARTON BOX

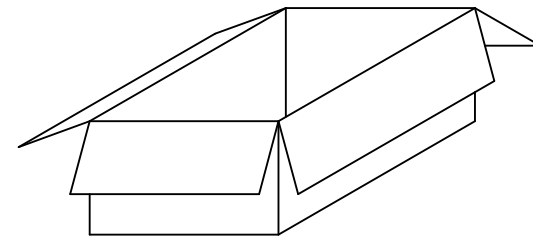

2 INNER CARTON (1080 PCS) IN OUTER CARTON BOX

| | | | | | | | | | | |
|--|-------------------------------|--|-------------|--------------------------|-------------|--|--|------------------------|-----------|--|
| SEE SHEET 1 EC NO: URF2010-0457 DRAWN: CHENG 2010/02/03 CHKD: ALEX 2009/5/19 APPR: MHIANG 2010/02/05 | QUALITY SYMBOLS ▽=0 ▽=0 | GENERAL TOLERANCES (UNLESS SPECIFIED) | | DIMENSION STYLE MM/IN | | SCALE | DESIGN UNITS METRIC | THIRD ANGLE PROJECTION | | |
| | | | mm | INCH | DRAWN BY | DATE | TITLE | | | |
| | | 4 PLACES ± --- | ± --- | ± --- | DARRY | 2009/5/19 | SMA JACK REVERSE SWITCH EDGE LAUNCH - LEFT SMA-J/SMT | | | |
| | | 3 PLACES ± --- | ± --- | ± --- | CHECKED BY | DATE | | | | |
| 2 PLACES ± 0.13 | ± --- | ± --- | ALEX | 2009/5/19 | | | | | | |
| 1 PLACE ± 0.25 | ± --- | ± --- | APPROVED BY | DATE | | | | | | |
| | | ANGULAR ± 2 ° | MHIANG | 2010/02/05 | | | | | | |
| | | DRAFT WHERE APPLICABLE MUST REMAIN WITHIN DIMENSIONS | | MATERIAL NO. | SEE SHEET 1 | DOCUMENT NO. | MOLEX INCORPORATED | | SHEET NO. | |
| B1 | REV | | | SIZE | C | THIS DRAWING CONTAINS INFORMATION THAT IS PROPRIETARY TO MOLEX INCORPORATED AND SHOULD NOT BE USED WITHOUT WRITTEN PERMISSION | | | 4 OF 4 | |