

MATERIALS AND FINISHES

BODY REAR BRASS
PLATED TIN $\triangle 1$

BODY FRONT BRASS
PLATED NICKEL $\triangle 2$

CENTER CONTACT PHOSPHOR BRONZE/BRASS
PLATED GOLD $\triangle 3$

OUTER CASING HIGH TEMPERATURE PLASTIC
KEYING SEE TABLE $\triangle 4$
COLOR SEE TABLE

INSULATOR TEFLON $\triangle 5$

PACKAGING BY TRAY

RETENTION SPECIFICATION

THE FAKRA CONNECTOR SHROUD WILL WITHSTAND
A LONGITUDINAL FORCE OF 110 N (24.75 LBS)

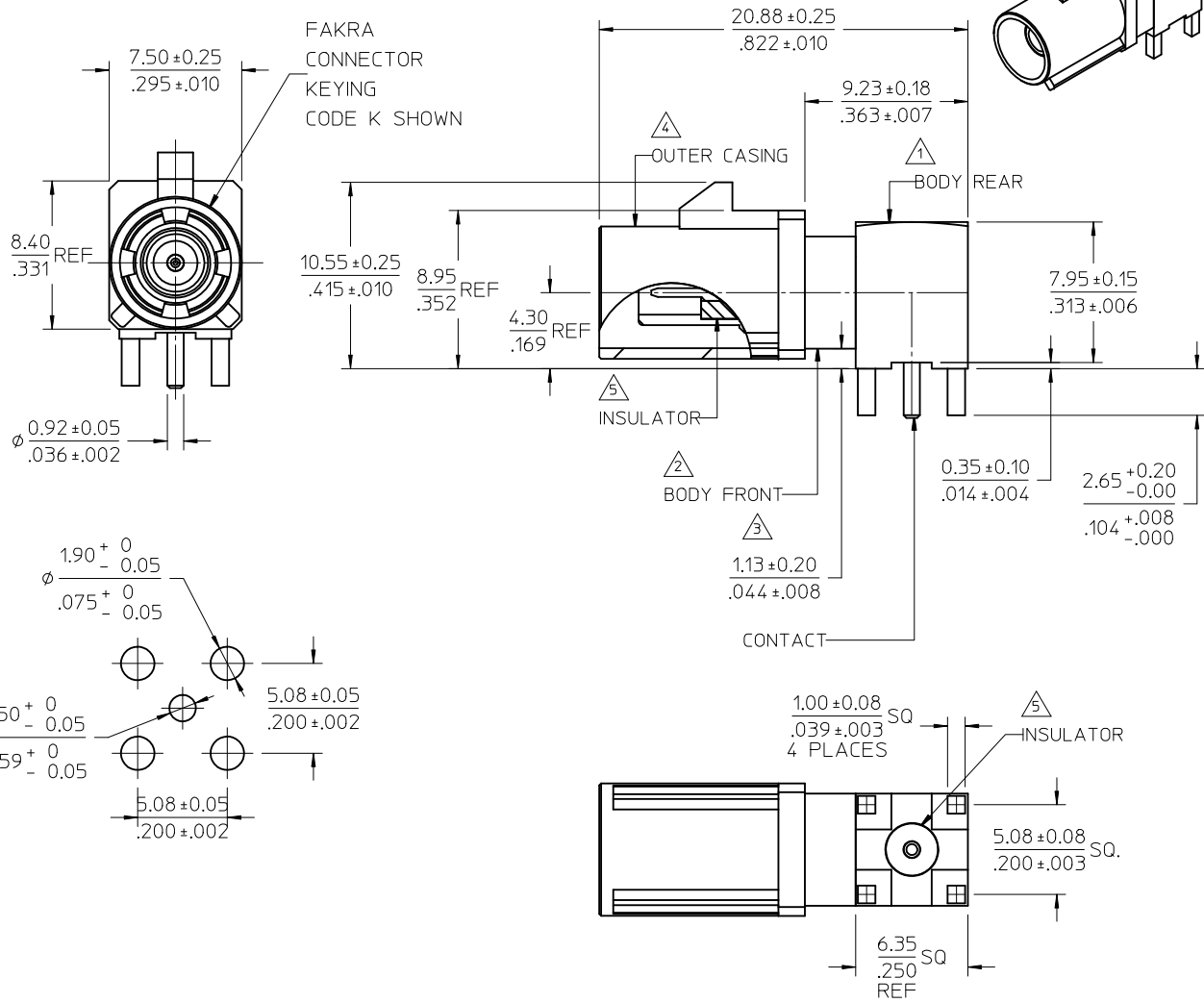

PS-89675-3310	PRODUCT SPECIFICATION
MIL-STD-348A, FIG. 311.1	INTERFACE SPECIFICATION
SPECIFICATION	DESCRIPTION

ADDED TOLERANCE 7.50 ± 0.25 WAS 7.50 REF.	EC NO: URF2010-0289
	DRWNLIN 2009/11/23
	CHKD: 2009/11/25
	APPR: MHIANG 2009/11/25
REV	DESCRIPTION
A5	

QUALITY SYMBOLS	$\nabla = 0$ $\nabla = 0$
GENERAL TOLERANCES (UNLESS SPECIFIED)	
	mm INCH
4 PLACES	± --- ± ---
3 PLACES	± --- ± ---
2 PLACES	± --- ± ---
1 PLACE	± --- ± ---
ANGULAR ± 2 °	
DRAFT WHERE APPLICABLE MUST REMAIN WITHIN DIMENSIONS	

DIMENSION STYLE		SCALE	DESIGN UNITS	THIRD ANGLE PROJECTION
MM/IN			METRIC	
DRAWN BY	DATE	TITLE		
JOYCE	2008/12/16	SMB JACK, FAKRA R/A		
CHECKED BY	DATE	PCB, 50 OHMS		
KERRIE	2008/12/16	SMB-J/PCB/RA		
APPROVED BY	DATE	MOLEX INCORPORATED		
MISEN	2008/12/16	DOCUMENT NO.		
MATERIAL NO.		SD-73403-511		
SIZE	THIS DRAWING CONTAINS INFORMATION THAT IS PROPRIETARY TO MOLEX INCORPORATED AND SHOULD NOT BE USED WITHOUT WRITTEN PERMISSION			

TITLE		SHEET NO.	
SMB JACK, FAKRA R/A		1 OF 2	
PCB, 50 OHMS			
SMB-J/PCB/RA			
MOLEX INCORPORATED			
DOCUMENT NO.			
SD-73403-511			

13

12

11

10

9

8

7

6

5

4

3

2

1

J

I

H

G

F

E

D

C

B

A

J

I

H

G

F

E

D

C

B

A

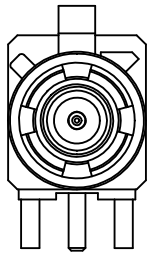

CODE-A

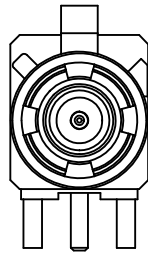

CODE-B

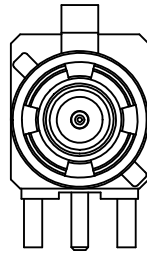

CODE-C

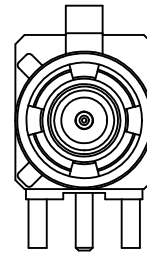

CODE-D

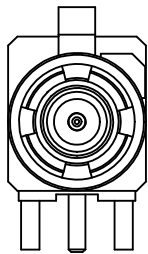

CODE-E

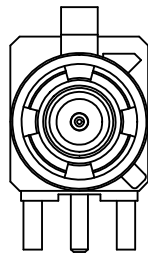

CODE-F

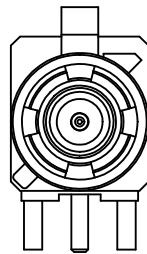

CODE-G

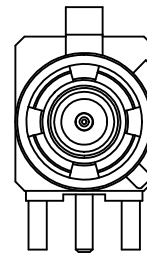

CODE-H

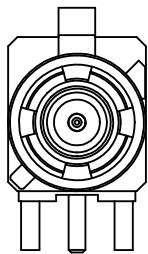

CODE-I

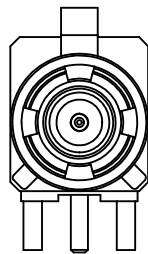

CODE-K

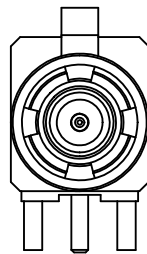

CODE-Z

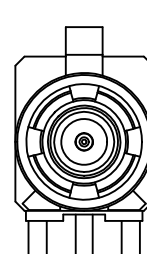

CODE-L

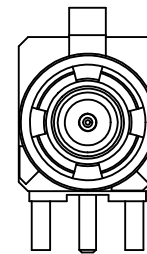

CODE-M

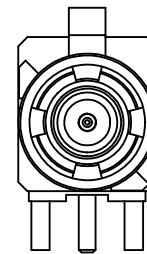

CODE-N

N	PASTEL GREEN	73403-5123
M	PASTEL ORANGE	73403-5122
L	CARMINE RED	73403-5121
Z	WATER BLUE	73403-5120
K	CURRY YELLOW	73403-5119
I	BEIGE	73403-5118
H	VIOLET	73403-5117
G	GRAY	73403-5116
F	BROWN	73403-5115
E	GREEN	73403-5114
D	BORDEAUXVIOLET	73403-5113
C	BLUE	73403-5112
B	NATURAL	73403-5111
A	BLACK	73403-5110
KEYING CODE	COLOR	PART NO.

SEE SHEET 1 EC NO: URF2010-0289 DRAWN IN: 2009/11/23 CHKD: 2009/11/25 APPR: MHIANG 2009/11/25 A5	QUALITY SYMBOLS = 0 = 0	GENERAL TOLERANCES (UNLESS SPECIFIED) <table border="1"> <thead> <tr> <th></th> <th>mm</th> <th>INCH</th> </tr> </thead> <tbody> <tr> <td>4 PLACES</td> <td>±---</td> <td>±---</td> </tr> <tr> <td>3 PLACES</td> <td>±---</td> <td>±---</td> </tr> <tr> <td>2 PLACES</td> <td>±---</td> <td>±---</td> </tr> <tr> <td>1 PLACE</td> <td>±---</td> <td>±---</td> </tr> </tbody> </table> ANGULAR ± 2°		mm	INCH	4 PLACES	±---	±---	3 PLACES	±---	±---	2 PLACES	±---	±---	1 PLACE	±---	±---	DIMENSION STYLE MM/IN	SCALE DESIGN UNITS METRIC	THIRD ANGLE PROJECTION
		mm	INCH																	
	4 PLACES	±---	±---																	
	3 PLACES	±---	±---																	
2 PLACES	±---	±---																		
1 PLACE	±---	±---																		
DRAFT WHERE APPLICABLE MUST REMAIN WITHIN DIMENSIONS	SEE TABLE	DRAWN BY: JOYCE DATE: 2008/12/16 CHECKED BY: KERRIE DATE: 2008/12/16 APPROVED BY: MISEN DATE: 2008/12/16	TITLE SMB JACK, FAKRA R/A PCB, 50 OHMS SMB-J/PCB/RA	MOLEX INCORPORATED	DOCUMENT NO. SD-73403-511															
			MATERIAL NO.	SHEET NO. 2 OF 2																
			THIS DRAWING CONTAINS INFORMATION THAT IS PROPRIETARY TO MOLEX INCORPORATED AND SHOULD NOT BE USED WITHOUT WRITTEN PERMISSION																	

12

11

10

9

8

7

6

5

4

3

2

1