

5	6	7	8
REV.	ECN NO.	DATE	SIGN

THIS DOCUMENT IS SUBJECT TO CHANGE WITHOUT NOTICE. IT IS CONFIDENTIAL AND A PROPERTY OF Amphenol LTW. DISCLOSURE TO THIRD PARTY HAS TO BE AUTHORIZED BY Amphenol LTW.

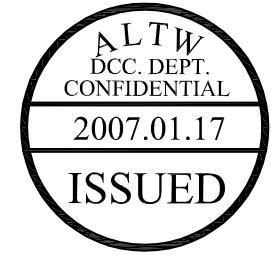

- Note:
- * @C Important Dimension To Check.
 - * Waterproof Rate: IP68
 - * Housing: Black, Nylon+GF
 - * Pin: Copper Alloy, Gold Plated
 - * Nut: Zinc Alloy, Nickel Plated
 - * Gasket: Black, EPDM
 - * Clamp Ring: Black, Nylon
 - * Sealing Nut: Black, Nylon
 - * Seal: Black, EPDM
 - * Seal For Cable OD: $\phi 4.5\text{mm} \sim \phi 6.5\text{mm}$

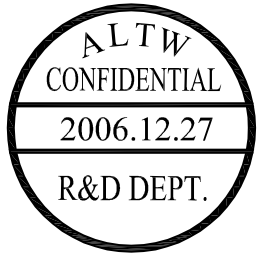
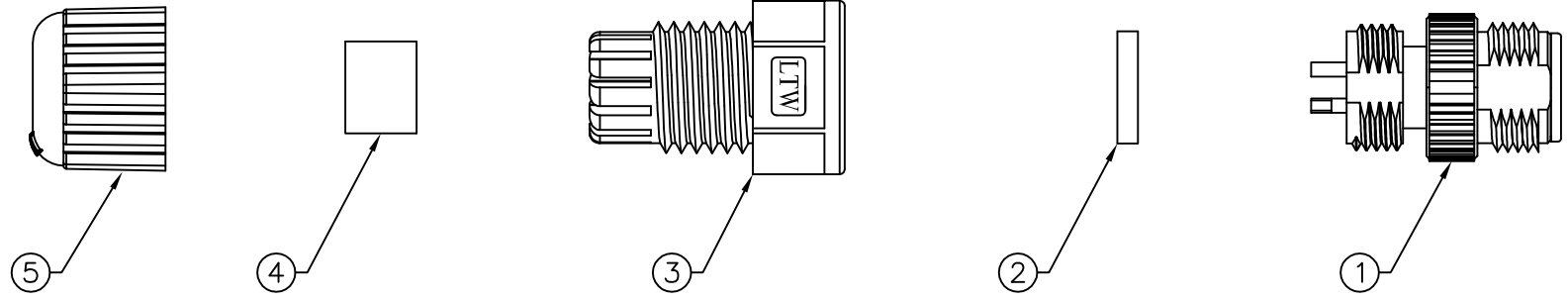
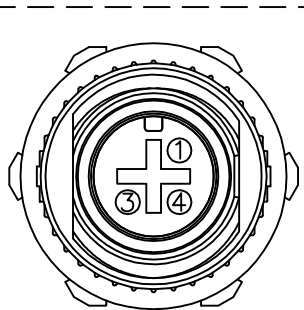

Pin Assignments
Front View

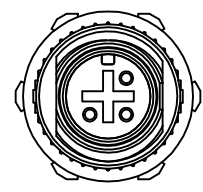
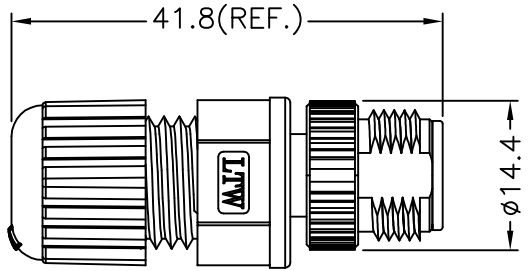

Conn.

UNIT:mm	
TOLERANCE	$\pm 0.5 \text{ mm}$

TITLE		M12 Conn	
Assy Screw 3Pin M Conn M Pin			
SCALE	Free	SHEET	1 OF 1
REV.	A	SIZE	A4
@C :Inspection Item			

Amphenol LTW
安費諾亮泰企業股份有限公司

ITEM NO	12-03BMMA-SL8001
DWG NO	12-03BMMA-SL8001
CUSTOMER	ALTW

DRAWN BY	Jason Manas
CHECKED BY	Michael Cerenado
APPROVED BY	Max

DATE	2006/12/27
DATE	2006/12/28
DATE	2006/12/28