

REV. A	EON NO.	DATE	SIGN	DESCRIPTION
B	LE3-710136	2006/12/14	DongYali	Released Rev.A Change DOR0023570 To DOR00010015 And Move DOR00010015 To ZS100100545

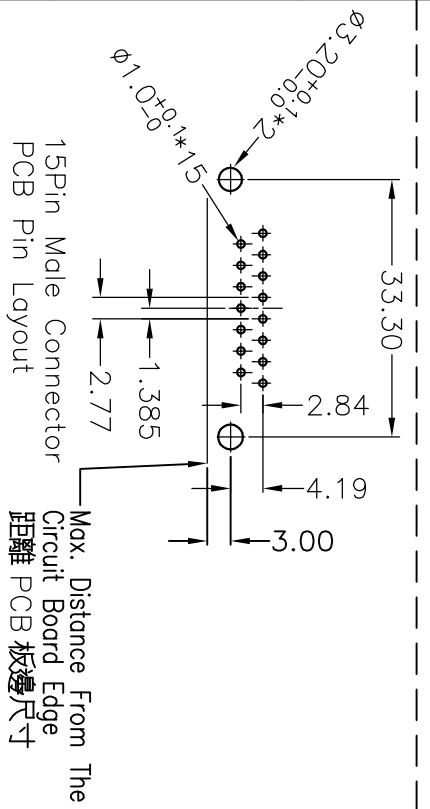

- Note:
- * \varnothing Important Dimension.
 - * Waterproof Rate : IP68
 - * IP68:1M of depth of water 24 hours (防水等級: IP68)
 - * (IP68:1米水深 24小時)
 - * Do Mating Test After Glued 點膠後, 須作對插測試
 - * D-SUB Conn.: Black Core,PBT
 - * Plastic Jacket : Black,Nylon+GF
 - * Pin:Copper Alloy , Gold Plated
 - * Ring:Light Blue,Silicone
 - * Screw:Copper Alloy,Nickel Plated #4-40 UNC
 - * The 90° Board Lock Needs To Connect The Iron Shell L型支架需接鐵殼

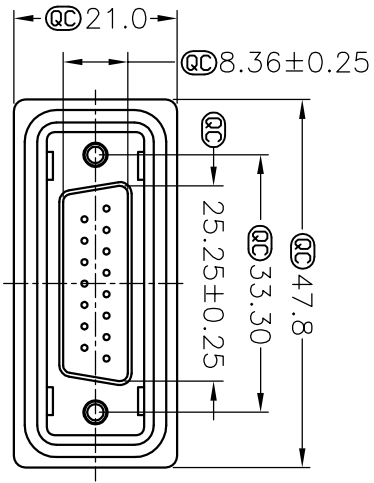
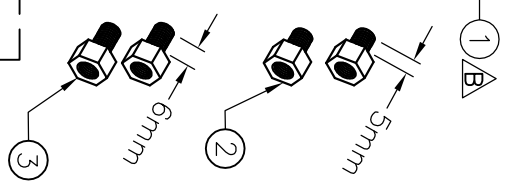
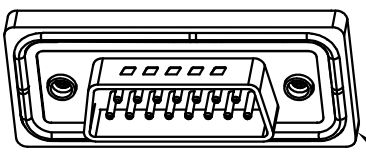
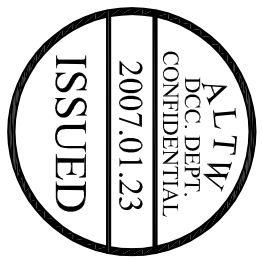
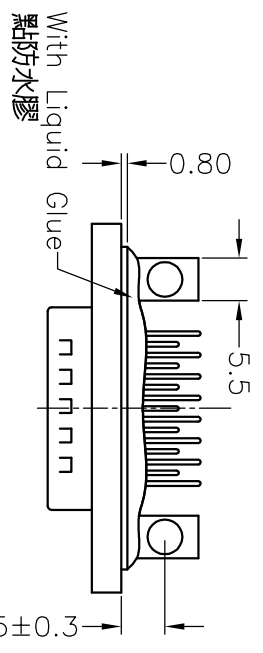
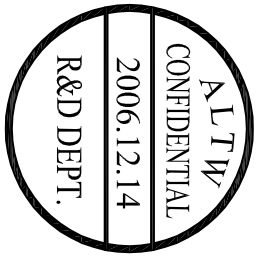
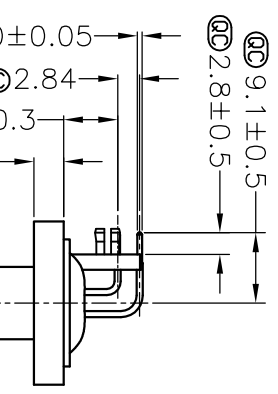
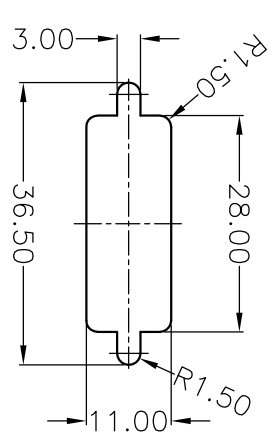
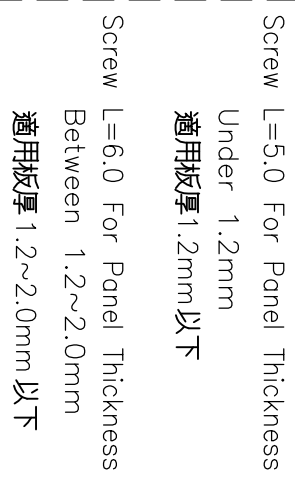
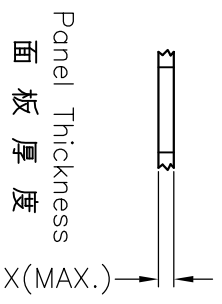

UNIT:mm	TITLE	SCALE	SHEET	OF	1
TOLERANCE	DB15/M Conn.,Panel,PCB 90°	F:Free	1	1	
XX ±0.25	Add Board Lock	SIZE	A4		
XXX ±0.1		REV.	B		
ANGLES ±1°		①: Inspection Item			

Amphenol LTW
安費諾亮泰企業股份有限公司

ITEM NO	SDB-15PMP-SB8001
DWG NO	SDB-15PMP-SB8001
CUSTOMER	ALLTW

DRAWN BY	DongYali	DATE	2006/12/14
CHECKED BY	SIMON	DATE	2006/12/22
APPROVED BY	MAX	DATE	2006/12/22